



Amisfield Street | | Glasgow | G20 8LD

Offers over £89,000

pattison&co



Amisfield Street |  
Glasgow | G20 8LD  
Offers over £89,000

**\*\* CLOSING DATE THURSDAY 26TH JUNE AT 12 NOON \*\***

Set within the vibrant area of Maryhill, Glasgow, this charming second-floor one-bedroom traditional tenement flat on Amisfield Street presents an exciting opportunity for both investors and first-time buyers seeking a project.

- Second floor tenement flat
- Spacious bay window living room
- Ideal for investors or first-time buyers
- Opportunity for upgrading project
- Nearby public transport links
- Traditional tenement style
- Viewing highly recommended

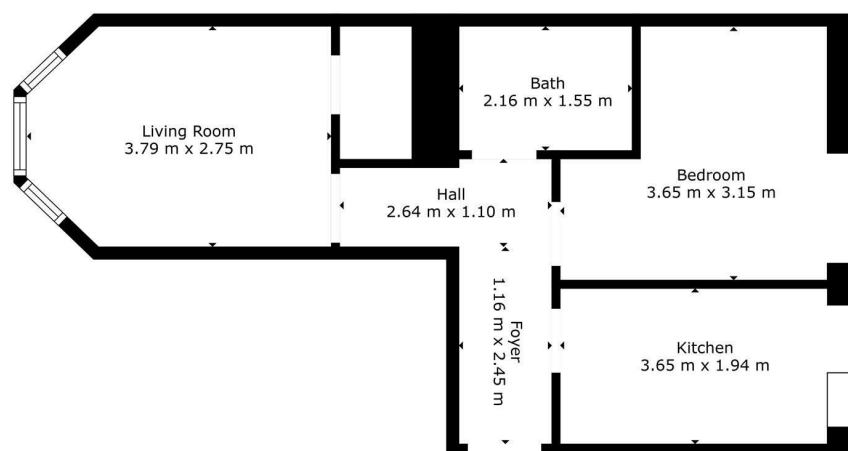

pattison&co

TOTAL: 39 m<sup>2</sup>  
FLOOR 1: 39 m<sup>2</sup>

Floorplan Created By Procreate Media. Measurements Deemed Highly Reliable But Not Guaranteed.



Energy Efficiency Rating		
	Current	Potential
Very energy efficient - lower running costs		
(92 plus) A		
(81-91) B		
(69-80) C		
(55-68) D		
(39-54) E		
(21-38) F		
(1-20) G		
Not energy efficient - higher running costs		
Scotland	72	81
	EU Directive 2002/91/EC	

103 Byres Road  
Glasgow  
G11 5HW  
0141 334 7706

melanie.paterson@pattisonandcompany.com  
<http://www.pattisonandcompany.com>