



Ben Venue Way | | Paisley | PA2 7NT

Offers over £119,000

pattison & co

Ben Venue Way |
 Paisley | PA2 7NT
 Offers over £119,000

*** CLOSING DATE SET FOR THURSDAY THE 2ND APRIL
 AT 12 NOON ***

Nestled in the desirable Hawkhead area of Paisley, this charming semi-detached bungalow on Ben Venue Way offers a delightful living experience. With two generously sized bedrooms, this home is perfect for small families, couples, or those seeking a comfortable retirement space.

- 2 spacious bedrooms
- Modern bathroom
- Bright living room
- Kitchen with cabinets
- Front and back gardens
- Spacious garage
- Semi-detached bungalow
- Located in Hawkhead
- Near local amenities
- Viewing recommended

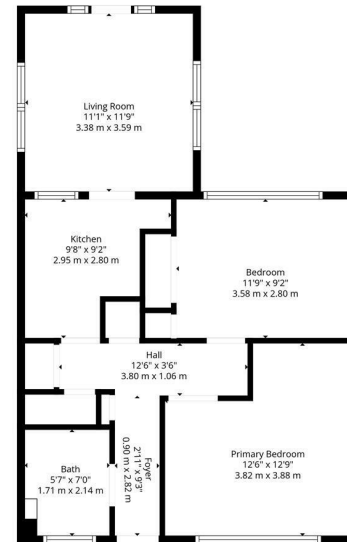

Total: 621 sq. Ft. 58 m2
 1st Floor: 621 sq. Ft. 58 m2
 Excluded Areas: Walls: 57 sq. Ft. 5 m2

Illustrative Purposes Only. Measurements Are Deemed Highly Reliable But Not Guaranteed.

Energy Efficiency Rating		Current	Potential
<i>Very energy efficient - lower running costs</i>			
(92 plus)	A		
(81-91)	B		
(69-80)	C		
(55-68)	D	63	74
(39-54)	E		
(21-38)	F		
(1-20)	G		
<i>Not energy efficient - higher running costs</i>			
Scotland		EU Directive 2002/91/EC	

103 Byres Road
 Glasgow
 G11 5HW
 0141 334 7706

melanie.paterson@pattisonandcompany.com
<http://www.pattisonandcompany.com>